

**G100 CONNECTING LINK**

Material: alloy steel

Technology: drop forged

Finish: powder coated

Design factor: 4:1

Marking: size, WLL, G100, trace code

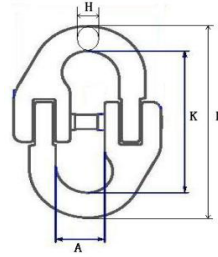

SIZE (mm)	Approx. Weight (kgs)	Dimensions (mm)				WLL (tons)
		A	L	K	H	
6	0.10	14.0	60.0	44.5	7.6	1.40
8	0.22	18.5	84.5	61.5	10.0	2.50
10	0.45	23.0	97.2	72.0	12.6	4.00
13	1.15	27.5	127.0	89.0	16.8	6.70
16	1.75	33.5	145.0	103.0	21.0	10.00
20	2.70	42.0	175.0	116.0	24.5	16.00
22	4.02	48.0	193.0	135.0	27.0	19.00
26	5.10	61.0	228.0	164.0	32.0	26.50
32	8.50	80.0	274.0	194.0	40.0	39.30

**G100 EYE SELF-LOCKING HOOK**

Material: alloy steel

Technology: drop forged

Finish: painted

Design factor: 4:1

Marking: size, WLL, G100, trace code

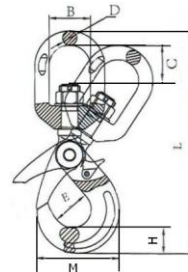

SIZE (mm)	Approx. Weight (kgs)	Dimensions (mm)							WLL (tons)
		B	C	D	E	H	M	L	
6	0.6	32.5	23	11.5	28	20	70	184	1.4
8	1.1	36	28	13	35.5	26	90	229	2.5
10	2	42	35	15.5	45	30	109	269	4
13	4	50	40	17	53.5	40.5	138.5	330	6.7
16	6.8	61	56	21.5	62	50.5	170.5	413	10
20	12.5	72	62	26	76.5	62	192.5	463	16
22	17.1	97	94	33	80	66	205	572	19

**G100 EYE SELF-LOCKING HOOK**

Material: alloy steel

Technology: drop forged

Finish: painted

Design factor: 4:1

Marking: size, WLL, G100, trace code

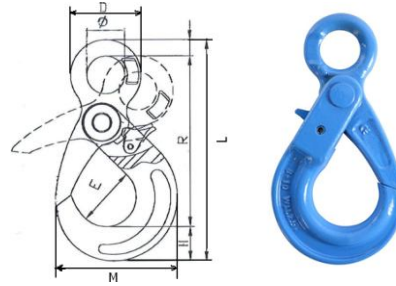

SIZE (mm)	Approx. Weight (kgs)	Dimensions (mm)							WLL (tons)
		Ø	D	E	H	R	M	L	
6	0.5	21	43	28	20	110	70	141	1.4
8	0.9	27	51	35.5	26	137	90	175	2.5
10	1.5	34.5	64.5	45	30	169	108	212.5	4
13	2.7	40	80	53.5	40.5	209	138.5	270	6.7
16	5.7	50	104	62	50.5	254	170.5	331	10
20	7.9	60	120	76.5	62	277	192.5	369	16
22	11.2	70	134	80	66	319.5	205	417	19

**G100 CLEVIS SELF-LOCKING HOOK**

Material: alloy steel

Technology: drop forged

Finish: painted

Design factor: 4:1

Marking: size, WLL, G100, trace code

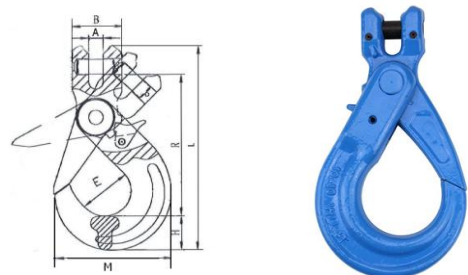

SIZE (mm)	Approx. Weight (kgs)	Dimensions (mm)							WLL (tons)
		A	B	E	H	R	M	L	
6	0.5	7.5	32	28	20	96	70	131	1.4
8	0.9	9.5	36	35.5	26	123	90	166	2.5
10	1.6	12	46	45	30	144	109	196.5	4
13	2.9	15	59	53.5	40.5	182	138.5	251	6.7
16	5.8	17.5	70	62	50.5	217	170.5	303	10
20	8.6	25	85	76.5	62	235	192.5	337.5	16
22	12.1	25.5	98	80	66	276.5	205	391	19

**G100 CLEVIS SLING HOOK WITH LATCH**

Material: alloy steel

Technology: drop forged

Finish: painted

Design factor: 4:1

Marking: size, WLL, G100, trace code

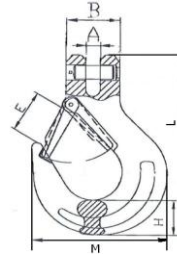

SIZE (mm)	Approx. Weight (kgs)	Dimensions (mm)						WLL (tons)
		A	B	E	H	M	L	
6	0.33	7.5	32	18.5	21	68.5	109	1.40
8	0.7	9.5	37	25	27.5	88	134	2.50
10	1.3	12	48	28	33.5	105.5	161.5	4.00
13	2.3	15	59	38	42	134	203	6.70
16	3.6	17.5	70	44	50	160.5	248	10.00
20	7.3	25	85	52	56	190.5	297	16.00
22	12.1	27	100	66	62	214.5	326	19.00

**G100 EYE SLING HOOK WITH LATCH**

Material: alloy steel

Technology: drop forged

Finish: painted

Design factor: 4:1

Marking: size, WLL, G100, trace code

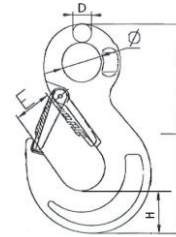

SIZE (mm)	Approx. Weight (kgs)	Dimensions (mm)					WLL (tons)
		D	E	H	Ø	L	
6	0.32	10	18.5	21	20.5	111	1.40
8	0.6	11	25	27.5	25	137.5	2.50
10	1.2	16	28	33	34	171.5	4.00
13	2.2	19	38	43.5	43	219	6.70
16	3.5	24.5	44	50	50	260	10.00
20	7.15	27	52	56	55	298	16.00
22	11.5	29	66	62	60	330	19.00
26	14	35	73	75	70	367	26.50
32	17.5	39	87	89	66	427	39.30

**G100 EYE SHORTENING GRAB HOOK**

Material: alloy steel

Technology: drop forged

Finish: painted

Design factor: 4:1

Marking: size, WLL, G100, trace code

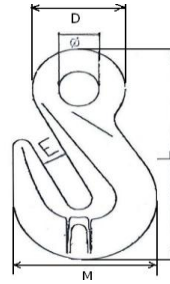

SIZE (mm)	Approx. Weight (kgs)	Dimensions (mm)					WLL (tons)
		E	Ø	D	M	L	
6	0.2	8	14.5	30.5	43.5	71	1.40
8	0.28	10.8	18	37	53	91.5	2.50
10	0.72	13.5	22.5	48.5	42	127.5	4.00
13	1.6	16.5	28	59	96	163	6.70
16	2.45	19.2	36	74	112.5	183	10.00
20	4.72	24	43.5	89.5	143	227	16.00
22	8.2	27	48.5	100.5	160.5	260.5	19.00

**G100 CLEVIS SHORTENING GRAB HOOK**

Material: alloy steel

Technology: drop forged

Finish: painted

Design factor: 4:1

Marking: size, WLL, G100, trace code

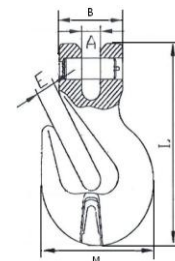

SIZE (mm)	Approx. Weight (kgs)	Dimensions (mm)					WLL (tons)
		A	B	E	M	L	
6	0.22	7.5	32	8	43.5	75	1.40
8	0.34	9.5	36	10.8	53	91.5	2.50
10	0.82	12	46	13.5	72	126	4.00
13	1.75	15	59	16.5	96	163.5	6.70
16	2.88	17.5	70	19.2	112.5	183.5	10.00
20	4.84	24	85	24	143	224	16.00
22	8.3	27	100	27	160.5	262	19.00

**G-100 MASTER LINK**

Material: alloy steel

Technology: drop forged

Finish: painted

Marking: size, WLL, G100, trace code



SIZE (mm)	Approx. Weight (kgs)	Dimensions (mm)			WLL (tons)
		D	A	B	
10	0.14	10.00	80.00	50.00	1.40
13	0.34	13.00	110.00	60.00	2.30
16	0.530	16.00	110.00	60.00	3.50
18	0.86	18.00	135.00	75.00	5.00
22	1.60	23.00	160.00	90.00	7.60
26	2.46	27.00	180.00	100.00	10.00
32	4.14	33.00	200.00	110.00	14.00
36	6.22	36.00	260.00	140.00	25.10
45	12.85	45.00	340.00	180.00	30.80
50	16.22	50.00	350.00	190.00	40.00
56	27.01	60.00	400.00	200.00	60.00
72	45.00	70.00	460.00	250.00	81.50

**G-100 SUB-ASSEMBLY**

Material: alloy steel

Technology: drop forged

Finish: painted

Marking: size, WLL, G100, trace code

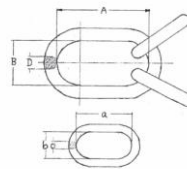

SIZE (mm)	Approx. Weight (kgs)	Dimensions (mm)						WLL (tons)
		Big Link			Small Links			
		D	A	B	d	a	b	
6	1.30	19.00	135.00	75.00	13.00	54.00	25.00	3.00
8	2.33	23.00	160.00	90.00	16.50	70.00	35.00	5.30
10	3.70	27.00	180.00	100.00	19.00	85.00	40.00	8.00
13	6.50	33.00	200.00	110.00	23.00	115.00	50.00	14.00
16	10.10	36.00	260.00	140.00	27.00	140.00	65.00	21.20
20	22.80	50.00	350.00	190.00	33.00	150.00	70.00	33.60
22	26.00	50.00	350.00	190.00	36.00	180.00	100.00	39.90